

Closing End Cap - MOD125

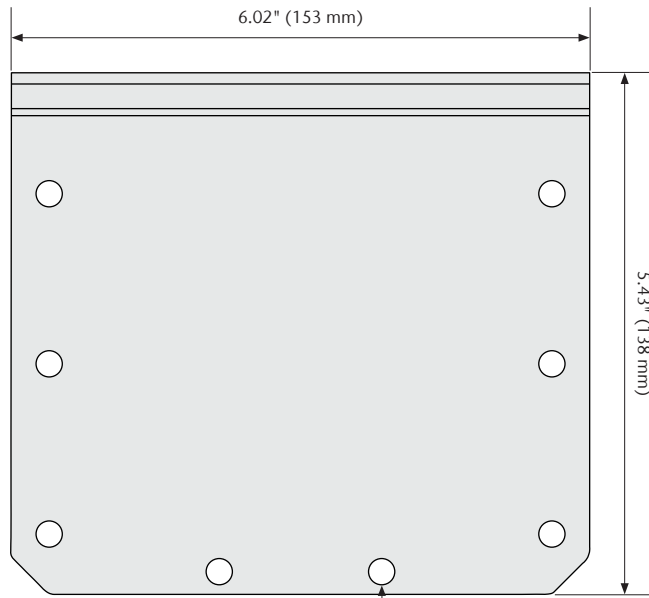
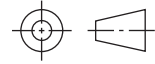

Ø0.28" (7 mm)  
Thru Holes For  
M6 Connection Bolts

**Specification Clause**

ACO Modular 125 closing end caps. Overall width 6.02", total height varies. Made from 16ga (1.5mm) AISI 304 or AISI 316L, pickle passivated finish. All caps provided with NBR seal and connection bolts. Used on ACO Modular 125 channels.

ACO recommends checking local plumbing codes prior to installation.

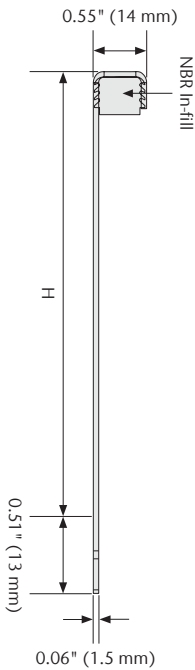

Part No.	Material	Height (H) in (mm)
105100	AISI 304	1.97 (50)
105101	AISI 304	2.56 (65)
105102	AISI 304	3.15 (80)
105103	AISI 304	3.74 (95)
105104	AISI 304	4.33 (110)
105105	AISI 304	4.92 (125)

Part No.	Material	Height (H) in (mm)
407196	AISI 316L	1.97 (50)
407197	AISI 316L	2.56 (65)
407198	AISI 316L	3.15 (80)
407199	AISI 316L	3.74 (95)
407200	AISI 316L	4.33 (110)
407201	AISI 316L	4.92 (125)

**ACO, Inc.**

West Sales Office  
825 W. Beechcraft Street  
Casa Grande, AZ 85122  
Tel: (520) 421-9988  
Toll-Free: (888) 490-9552  
Fax: (520) 421-9899

Northeast Sales Office  
9470 Pinecone Drive  
Mentor, OH 44060  
Tel: (440) 639-7230  
Toll-Free: (800) 543-4764  
Fax: (440) 639-7235

Southeast Sales Office  
4211 Pleasant Road  
Fort Mill, SC 29708  
Toll-Free: (800) 543-4764  
Fax: (803) 802-1063

info@acousa.com  
www.acousa.com

© December 2021 ACO, Inc.

All reasonable care has been taken in compiling the information in this document. All recommendations and suggestions on the use of ACO products are made without guarantee since the conditions of use are beyond the control of the company. It is the customer's responsibility to ensure that each product is fit for its intended purpose and that the actual conditions of use are suitable. ACO, Inc. reserves the right to change products and specifications without notice.

ACO. creating  
the future of drainage



ACO Specification Information