

ACO Hub Drain

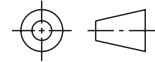
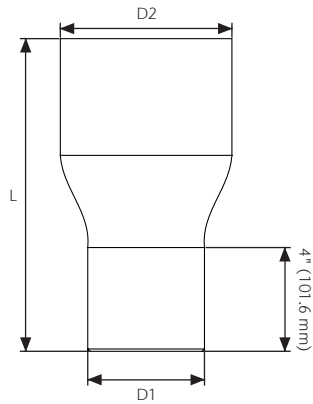

Specifications

General

ACO Hub Drain. Fully welded 304/316L* SCH10/SCH40* with Outlet Diameter 2" - 10" and 2" concentrically increased top. Used with ACO Pipe, including Elbows, P-Traps or Long Swept P-Traps, which are available in the same thickness and grade material. Designed for direct discharge and gravity piping system. Contact ACO for optional trap primers, strainer baskets, covers, setting rings and custom sizes.

*delete as necessary

ACO recommends checking local plumbing codes prior to installation.

Optional assembly includes a FloorDrain installed flush with finished floor with Funnel Grate, which is replaceable if damaged.

	Part No.	Diameter (D1) in (mm)	Diameter (D2) in (mm)	Length (L) in (mm)	Thickness in (mm)	Material	Weight lbs
2"	448814	2.375 (60.3)	4.5 (114.3)	12 (305)	SCH10 (2.8)	304	4.2
	448826	2.375 (60.3)	4.5 (114.3)	12 (305)	SCH10 (2.8)	316L	4.2
	448820	2.375 (60.3)	4.5 (114.3)	12 (305)	SCH40 (3.9)	304	7.2
	448832	2.375 (60.3)	4.5 (114.3)	12 (305)	SCH40 (3.9)	316L	7.2
3"	448815	3.50 (88.9)	6.625 (168.3)	12 (305)	SCH10 (3.1)	304	6.9
	448827	3.50 (88.9)	6.625 (168.3)	12 (305)	SCH10 (3.1)	316L	6.9
	448821	3.50 (88.9)	6.625 (168.3)	12 (305)	SCH40 (5.5)	304	13.2
	448833	3.50 (88.9)	6.625 (168.3)	12 (305)	SCH40 (5.5)	316L	13.2
4"	448816	4.50 (114.3)	6.625 (168.3)	12 (305)	SCH10 (3.1)	304	7.5
	448828	4.50 (114.3)	6.625 (168.3)	12 (305)	SCH10 (3.1)	316L	7.5
	448822	4.50 (114.3)	6.625 (168.3)	12 (305)	SCH40 (6)	304	14.9
	448834	4.50 (114.3)	6.625 (168.3)	12 (305)	SCH40 (6)	316L	14.9
6"	448817	6.625 (168.3)	8.625 (219)	14 (356)	SCH10 (3.4)	304	13.4
	448829	6.625 (168.3)	8.625 (219)	14 (356)	SCH10 (3.4)	316L	13.4
	448823	6.625 (168.3)	8.625 (219)	14 (356)	SCH40 (7.1)	304	27.7
	448835	6.625 (168.3)	8.625 (219)	14 (356)	SCH40 (7.1)	316L	27.7
8"	448818	8.625 (219)	10.75 (273)	16 (406)	SCH10 (3.8)	304	21.6
	448830	8.625 (219)	10.75 (273)	16 (406)	SCH10 (3.8)	316L	21.6
	448824	8.625 (219)	10.75 (273)	16 (406)	SCH40 (7.2)	304	46.0
	448836	8.625 (219)	10.75 (273)	16 (406)	SCH40 (7.2)	316L	46.0
10"	448819	10.75 (273)	12.75 (324)	16 (406)	SCH10 (4.2)	304	28.8
	448831	10.75 (273)	12.75 (324)	16 (406)	SCH10 (4.2)	316L	28.8
	448825	10.75 (273)	12.75 (324)	16 (406)	SCH40 (9.3)	304	60.0
	448837	10.75 (273)	12.75 (324)	16 (406)	SCH40 (9.3)	316L	60.0

ACO, Inc.

West Sales Office info@acousa.com
 825 W. Beechcraft Street www.acousa.com
 Casa Grande, AZ 85122 www.acobuildingdrainage.us
 Tel: (520) 421-9988
 Toll-Free: (888) 490-9552
 Fax: (520) 421-9899

© February 2022 ACO, Inc.
 All reasonable care has been taken in compiling the information in this document. All recommendations and suggestions on the use of ACO products are made without guarantee since the conditions of use are beyond the control of the company. It is the customer's responsibility to ensure that each product is fit for its intended purpose and that the actual conditions of use are suitable. ACO, Inc. reserves the right to change products and specifications without notice.

ACO. creating the future of drainage



ACO Specification Information