

ShowerDrain Premium ShowerChannel Grate - Quadrato

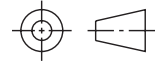

Quadrato

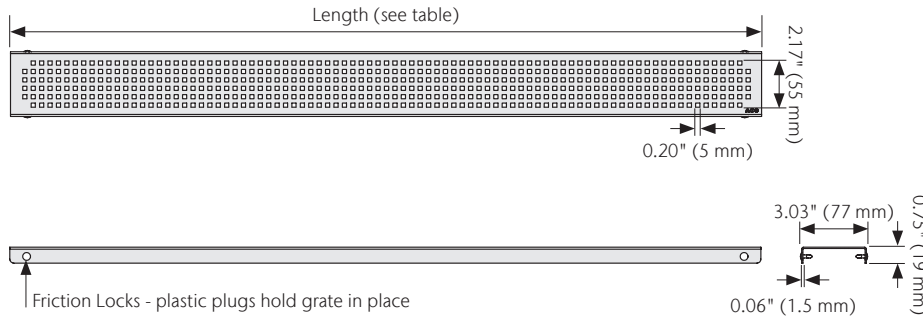

Specification Clause

The ACO ShowerDrain Quadrato grate shall be 1.5 mm (16 gauge) stainless steel grade 304 manufactured by ACO, Inc. USA.

Grates shall be 3.03" (77 mm) wide with length as specified on Architect's plans/specification.

Shower channel shall be Plain Edge OR Flange Edge. See separate Spec Info Sheet for details.

ACO recommends checking local plumbing codes prior to installation.

The system shall be installed in accordance with the manufacturer's instructions and recommendations.

Classic Finish	Length in (mm)	Part No.	Intake in ² (cm ²)	Weight lbs
Brushed Stainless	27.55 (700)	37359	15.39 (99.3)	1.7
	31.50 (800)	37360	17.71 (114.3)	1.9
	35.43 (900)	37361	20.02 (129.3)	2.1
	39.37 (1000)	37362	22.35 (144.2)	2.4
	47.25 (1200)	37363	26.68 (172.2)	2.9
	55.12 (1400)	37418	31.01 (200.1)	3.4
	59.05 (1500)	37390	34.26 (221.0)	3.8
Polished Chrome	27.55 (700)	37520	15.39 (99.3)	1.7
	31.50 (800)	37521	17.71 (114.3)	1.9
	35.43 (900)	37522	20.02 (129.3)	2.1
	39.37 (1000)	37523	22.35 (144.2)	2.4
	47.25 (1200)	37524	26.68 (172.2)	2.9
	55.12 (1400)	37525	31.01 (200.1)	3.4
	59.05 (1500)	37526	34.26 (221.0)	3.8
Matte Black	27.55 (700)	37569	15.39 (99.3)	1.7
	31.50 (800)	37570	17.71 (114.3)	1.9
	35.43 (900)	37571	20.02 (129.3)	2.1
	39.37 (1000)	37572	22.35 (144.2)	2.4
	47.25 (1200)	37573	26.68 (172.2)	2.9
	55.12 (1400)	37574	31.01 (200.1)	3.4
	59.05 (1500)	37575	34.26 (221.0)	3.8

Luxury Finish	Length in (mm)	Part No.	Intake in ² (cm ²)	Weight lbs
Oil-Rubbed Bronze	27.55 (700)	37317	15.39 (99.3)	1.7
	31.50 (800)	37639	17.71 (114.3)	1.9
	35.43 (900)	37303	20.02 (129.3)	2.1
	39.37 (1000)	37640	22.35 (144.2)	2.4
	47.25 (1200)	37307	26.68 (172.2)	2.9
	55.12 (1400)	37641	31.01 (200.1)	3.4
	59.05 (1500)	37642	34.26 (221.0)	3.8
Satin Brass	27.55 (700)	37697	15.39 (99.3)	1.7
	31.50 (800)	37698	17.71 (114.3)	1.9
	35.43 (900)	37699	20.02 (129.3)	2.1
	39.37 (1000)	37700	22.35 (144.2)	2.4
	47.25 (1200)	37701	26.68 (172.2)	2.9
	55.12 (1400)	37702	31.01 (200.1)	3.4
	59.05 (1500)	37703	34.26 (221.0)	3.8
Rose Gold	27.55 (700)	37769	15.39 (99.3)	1.7
	31.50 (800)	37770	17.71 (114.3)	1.9
	35.43 (900)	37771	20.02 (129.3)	2.1
	39.37 (1000)	37772	22.35 (144.2)	2.4
	47.25 (1200)	37773	26.68 (172.2)	2.9
	55.12 (1400)	37774	31.01 (200.1)	3.4
	59.05 (1500)	37775	34.26 (221.0)	3.8
Black Nickel	27.55 (700)	37839	15.39 (99.3)	1.7
	31.50 (800)	37840	17.71 (114.3)	1.9
	35.43 (900)	37841	20.02 (129.3)	2.1
	39.37 (1000)	37842	22.35 (144.2)	2.4
	47.25 (1200)	37843	26.68 (172.2)	2.9
	55.12 (1400)	37844	31.01 (200.1)	3.4
	59.05 (1500)	37845	34.26 (221.0)	3.8

Grate Lifting Key (part no. 37339) included.

ACO, Inc.

West Sales Office
825 W. Beechcraft Street
Casa Grande, AZ 85122
Tel: (520) 421-9988
Toll-Free: (888) 490-9552
Fax: (520) 421-9899

Northeast Sales Office
9470 Pinecone Drive
Mentor, OH 44060
Tel: (440) 639-7230
Toll-Free: (800) 543-4764
Fax: (440) 639-7235

Southeast Sales Office
4211 Pleasant Road
Fort Mill, SC 29708
Toll-Free: (800) 543-4764
Fax: (803) 802-1063

info@acousa.com
www.acousa.com

© December 2021 ACO, Inc.

All reasonable care has been taken in compiling the information in this document. All recommendations and suggestions on the use of ACO products are made without guarantee since the conditions of use are beyond the control of the company. It is the customer's responsibility to ensure that each product is fit for its intended purpose and that the actual conditions of use are suitable. ACO, Inc. reserves the right to change products and specifications without notice.

ACO. creating the future of drainage



ACO Specification Information