

ShowerDrain Premium ShowerChannel Grate - Hawaii

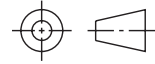

Hawaii

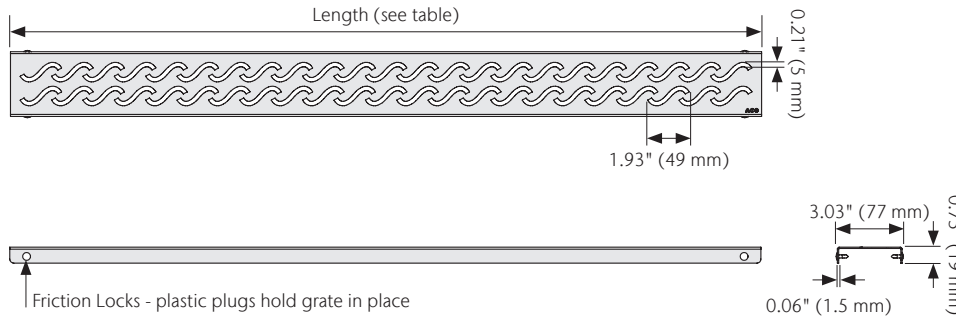

Specification Clause

The ACO ShowerDrain Hawaii grate shall be 1.5 mm (16 gauge) stainless steel grade 304 manufactured by ACO, Inc. USA.

Grates shall be 3.03" (77 mm) wide with length as specified on Architect's plans/specification.

Shower channel shall be Plain Edge OR Flange Edge. See separate Spec Info Sheet for details.

ACO recommends checking local plumbing codes prior to installation.

The system shall be installed in accordance with the manufacturer's instructions and recommendations.

Classic Finish	Length in (mm)	Part No.	Intake in ² (cm ²)	Weight lbs
Brushed Stainless	27.55 (700)	37398	15.73 (101.5)	1.6
	31.50 (800)	37399	17.48 (112.8)	1.8
	35.43 (900)	37400	19.22 (124.0)	2.1
	39.37 (1000)	37401	22.72 (146.6)	2.2
	47.24 (1200)	37402	26.22 (169.2)	2.8
Polished Chrome	55.12 (1400)	37414	29.72 (191.8)	3.4
	59.05 (1500)	37384	35.14 (226.7)	3.8
	27.55 (700)	37499	15.73 (101.5)	1.6
	31.50 (800)	37500	17.48 (112.8)	1.8
	35.43 (900)	37501	19.22 (124.0)	2.1
Matte Black	39.37 (1000)	37502	22.72 (146.6)	2.2
	47.24 (1200)	37503	26.22 (169.2)	2.8
	55.12 (1400)	37504	29.72 (191.8)	3.4
	59.05 (1500)	37505	35.14 (226.7)	3.8
	27.55 (700)	37548	15.73 (101.5)	1.6
	31.50 (800)	37549	17.48 (112.8)	1.8
	35.43 (900)	37550	19.22 (124.0)	2.1
	39.37 (1000)	37551	22.72 (146.6)	2.2
	47.24 (1200)	37552	26.22 (169.2)	2.8
	55.12 (1400)	37553	29.72 (191.8)	3.4
59.05 (1500)	37554	35.14 (226.7)	3.8	

Grate Lifting Key (part no. 37339) included.

Luxury Finish	Length in (mm)	Part No.	Intake in ² (cm ²)	Weight lbs
Oil-Rubbed Bronze	27.55 (700)	37618	15.73 (101.5)	1.6
	31.50 (800)	37619	17.48 (112.8)	1.8
	35.43 (900)	37620	19.22 (124.0)	2.1
	39.37 (1000)	37621	22.72 (146.6)	2.2
	47.24 (1200)	37622	26.22 (169.2)	2.8
Satin Brass	55.12 (1400)	37623	29.72 (191.8)	3.4
	59.05 (1500)	37624	35.14 (226.7)	3.8
	27.55 (700)	37676	15.73 (101.5)	1.6
	31.50 (800)	37677	17.48 (112.8)	1.8
	35.43 (900)	37678	19.22 (124.0)	2.1
Rose Gold	39.37 (1000)	37679	22.72 (146.6)	2.2
	47.24 (1200)	37680	26.22 (169.2)	2.8
	55.12 (1400)	37681	29.72 (191.8)	3.4
	59.05 (1500)	37682	35.14 (226.7)	3.8
	27.55 (700)	37748	15.73 (101.5)	1.6
Black Nickel	31.50 (800)	37749	17.48 (112.8)	1.8
	35.43 (900)	37750	19.22 (124.0)	2.1
	39.37 (1000)	37751	22.72 (146.6)	2.2
	47.24 (1200)	37752	26.22 (169.2)	2.8
	55.12 (1400)	37753	29.72 (191.8)	3.4
59.05 (1500)	37754	35.14 (226.7)	3.8	
	27.55 (700)	37818	15.73 (101.5)	1.6
	31.50 (800)	37819	17.48 (112.8)	1.8
	35.43 (900)	37820	19.22 (124.0)	2.1
	39.37 (1000)	37821	22.72 (146.6)	2.2
	47.24 (1200)	37822	26.22 (169.2)	2.8
55.12 (1400)	37823	29.72 (191.8)	3.4	
59.05 (1500)	37824	35.14 (226.7)	3.8	

ACO, Inc.

West Sales Office
825 W. Beechcraft Street
Casa Grande, AZ 85122
Tel: (520) 421-9988
Toll-Free: (888) 490-9552
Fax: (520) 421-9899

Northeast Sales Office
9470 Pinecone Drive
Mentor, OH 44060
Tel: (440) 639-7230
Toll-Free: (800) 543-4764
Fax: (440) 639-7235

Southeast Sales Office
4211 Pleasant Road
Fort Mill, SC 29708
Toll-Free: (800) 543-4764
Fax: (803) 802-1063

info@acousa.com
www.acousa.com

© December 2021 ACO, Inc.

All reasonable care has been taken in compiling the information in this document. All recommendations and suggestions on the use of ACO products are made without guarantee since the conditions of use are beyond the control of the company. It is the customer's responsibility to ensure that each product is fit for its intended purpose and that the actual conditions of use are suitable. ACO, Inc. reserves the right to change products and specifications without notice.

ACO. creating the future of drainage



ACO Specification Information