

# KlassikDrain - Type 878Q Longitudinal Ductile Iron Grate

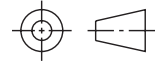

**Type 878Q Longitudinal Ductile Iron Grate**  
part no. 138130

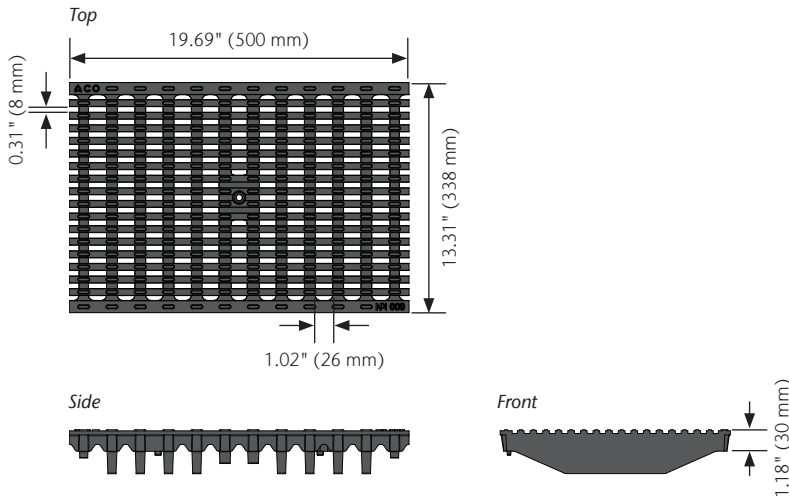

**Product Features**

- Certified to EN 1433 Load Class E - 134,885 lbs - 2,321 psi
- Uses QuickLok boltless locking system
- Suitable for use with K300, KS300, H300K-13 and H300KS-13 channels and 621G, 621S, 631G and 631S catch basins
- Manufactured from ductile iron to ASTM 536 - Grade 80-55-06
- E-coated for improved resistance against corrosion
- Complies with ADA - American Disabilities Act of 2010 Section 302.3
- Complies with ASME: A112.6.3 - 2001: Section 7.12 Heel Resistance
- Bicycle Tire Penetration Resistant to AS 3996 - 2006

**QuickLok® Locking Mechanism**

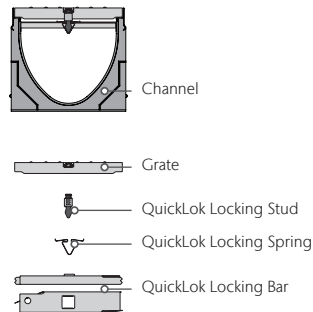

ACO QuickLok is a patented, boltless locking system which allows grates to be removed and replaced with minimum time and effort for ease of maintenance. The unique design allows the grate to snap down and fit into the locking bar. A stud is fixed to the grate which locks into the spring clip in the locking bar.

The QuickLok bar and clip are made from stainless steel, while the stud is made from stainless steel and high-density nylon. ACO QuickLok is for use in both general purpose and corrosive environments.

	Part No.	Length in (mm)	Width in (mm)	Weight lbs
Type 878Q Ductile Iron Longitudinal Grate	<b>138130</b>	19.69 (500)	13.31 (338)	52.0
QuickLok Locking Bar	<b>02899</b>	-	-	0.2
QuickLok Grate Removal Tool	<b>01318</b>	-	-	0.6

**Specifications**

**General**

The surface drainage system shall be ACO Drain K300, KS300, H300K-13, and H300KS-13, channels and 621G, 621S, 631G, and 631S catch basins complete with ACO Type 878Q longitudinal ductile iron grate with QuickLok locking as manufactured by ACO, Inc. or similar approved.

**Materials**

The covers shall be manufactured from stainless steel and have minimum properties as follows:

- Independently certified to meet Load Class E to EN 1433 - 134,885 lbs - 2,321 psi
- Ductile iron to ASTM 536 - Grade 80-55-06
- Intake area of 61.85 in<sup>2</sup> (399 cm<sup>2</sup>) per 0.5 m of grate

The overall width of 13.31" (338 mm) and overall length of 19.69" (0.5 m). Slots measure at a maximum of 1.02" (26 mm) by 0.31" (8 mm).

**Installation**

The trench drain system and grates shall be installed in accordance with the manufacturer's installation instructions and recommendations.

- ADA Compliant
- Bicycle-Safe
- Heel-Resistant (slot width ≤0.31" (8 mm))
- Heel-Safe (slot width ≤0.25" (6.5 mm))
- EN 1433 Load Class E 134,885 lbs - 2,321 psi

**ACO, Inc.**

West Sales Office  
825 W. Beechcraft Street  
Casa Grande, AZ 85122  
Tel: (520) 421-9988  
Toll-Free: (888) 490-9552  
Fax: (520) 421-9899

Northeast Sales Office  
9470 Pinecone Drive  
Mentor, OH 44060  
Tel: (440) 639-7230  
Toll-Free: (800) 543-4764  
Fax: (440) 639-7235

Southeast Sales Office  
4211 Pleasant Road  
Fort Mill, SC 29708  
Toll-Free: (800) 543-4764  
Fax: (803) 802-1063

info@acousa.com  
www.acousa.com

© August 2021 ACO, Inc.

All reasonable care has been taken in compiling the information in this document. All recommendations and suggestions on the use of ACO products are made without guarantee since the conditions of use are beyond the control of the company. It is the customer's responsibility to ensure that each product is fit for its intended purpose and that the actual conditions of use are suitable. ACO, Inc. reserves the right to change products and specifications without notice.

ACO. creating the future of drainage



ACO Specification Information