

KlassikDrain - Type 405D/406D Mesh Galvanized Steel Grate

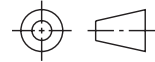

Type 405D Mesh Galvanized Steel Grate
part no. 132880

Top

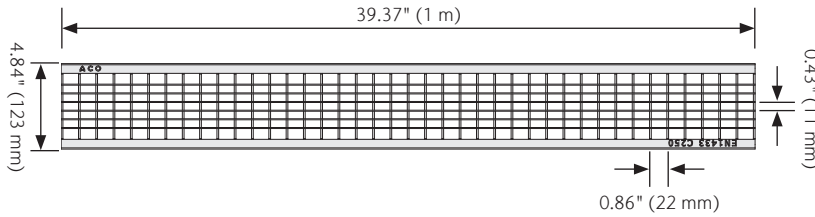

Side

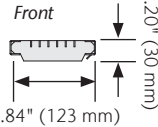

Type 406D Mesh Galvanized Steel Grate
part no. 132881

Top

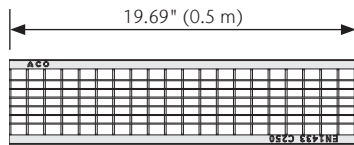

DrainLok Locking Mechanism

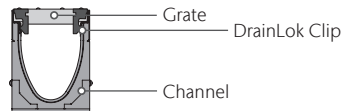

ACO DrainLok is a patented, boltless locking system that removes the need for bolts and bars while improving the hydraulic capacity of the channel. DrainLok Clips lock into the channel's edge rail for rapid installation. ACO DrainLok grates are fitted with an anti-shunt mechanism that restricts unwanted grate movement when installed, improving durability and longevity of the system.

Product Features

- Certified to EN 1433 Load Class C - 56,202 lbs - 1,934 psi
- Uses DrainLok boltless locking system
- Suitable for use with K100, KS100, H100K-8, HS100K-8, H100K-6 and H100KS-6 channels
- Manufactured from 13 gauge galvanized steel
- Complies with ADA - American Disabilities Act of 2010 Section 302.3
- Bicycle Tire Penetration Resistant to AS 3996 - 2006

	Part No.	Length in (m)	Width in (mm)	Weight lbs
Type 405D Mesh Galvanized Steel Grate	132880	39.37 (1)	4.84 (123)	9.1
Type 406D Mesh Galvanized Steel Grate	132881	19.69 (0.5)	4.84 (123)	4.6

ACO, Inc.

West Sales Office
825 W. Beechcraft Street
Casa Grande, AZ 85122
Tel: (520) 421-9988
Toll-Free: (888) 490-9552
Fax: (520) 421-9899

Northeast Sales Office
9470 Pinecone Drive
Mentor, OH 44060
Tel: (440) 639-7230
Toll-Free: (800) 543-4764
Fax: (440) 639-7235

Southeast Sales Office
4211 Pleasant Road
Fort Mill, SC 29708
Toll-Free: (800) 543-4764
Fax: (803) 802-1063

info@acousa.com
www.acousa.com

© February 2021 ACO, Inc.

All reasonable care has been taken in compiling the information in this document. All recommendations and suggestions on the use of ACO products are made without guarantee since the conditions of use are beyond the control of the company. It is the customer's responsibility to ensure that each product is fit for its intended purpose and that the actual conditions of use are suitable. ACO, Inc. reserves the right to change products and specifications without notice.

Specifications

General

The surface drainage system shall be ACO Drain K100, KS100, H100K-8, HS100K-8, H100K-6, and H100KS-6 channels, complete with ACO Type 405D/406D mesh galvanized steel grate with DrainLok locking as manufactured by ACO, Inc. or similar approved.

Materials

The covers shall be manufactured from stainless steel and have minimum properties as follows:

- Independently certified to meet Load Class C to EN 1433 - 56,202 lbs - 1,934 psi
- 13 gauge galvanized steel
- Intake area of 58.0 in² (374.2 cm²) per half meter of grate

The overall width of 4.84" (123 mm) and overall length of 39.37" (1 m) (Type 405D) and 19.69" (0.5 m) (Type 406D). Slots measure at 0.86" (22 mm) by 0.43" (11 mm).

Installation

The trench drain system and grates shall be installed in accordance with the manufacturer's installation instructions and recommendations.



ADA Compliant



Bicycle Safe



Anti-Slip Grates



EN 1433 Load Class C
56,202 lbs - 1,934 psi

ACO Specification Information

