

ACO Self

Residential & Landscape Products

PointDrains are ideal drainage solutions for small scale applications where problems with complex ground slopes are not an issue. Choose from polymer concrete or black propylene plastic bodies and a variety of grate options.

Suitable for pedestrian/light vehicle traffic applications such as:

- Gardens
- Patios
- Walkways
- Driveways



Product Overview

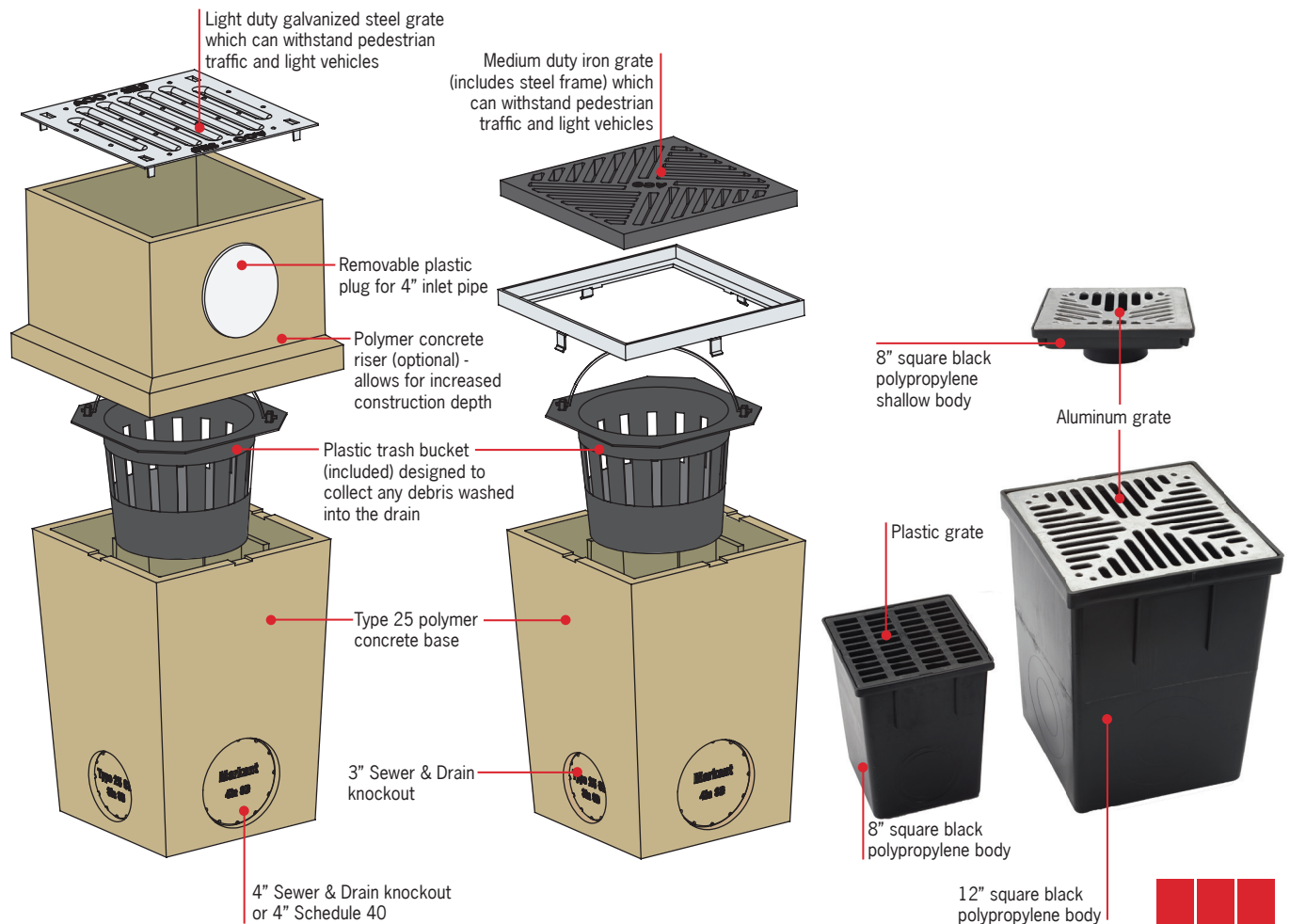

Part Table

	Part No.	Length in.	Width in.	Height in.	Wgt. lbs.
Complete Units					
10" Polymer concrete base w/frame & iron grate	01583	9.9	8.5	13.9	37.2
10" Polymer concrete base w/galvanized grate	36893	10.2	8.5	14.5	27.25
Optional					
10" Polymer concrete riser	02102	9.8	11.0	8.3	16.07
Point Drain Bases					
12" Plastic base	78030	11.8	11.8	11.8	3.7
8" Plastic base	78023	7.87	7.87	10.8	1.75
8" Shallow plastic base	99211684	7.87	7.87	3.15	0.3
Point Drain Grates					
8" Aluminum grate	78002	7.87	7.87	0.39	3.5
8" Plastic grate	77997	7.87	7.87	0.39	0.5
12" Plastic grate	73681	11.8	11.8	0.81	2.5
12" Aluminum grate	78019	11.8	11.8	0.81	8.8



Installation Instructions



1 Dig hole to fit PointDrain and necessary pipe-work.



2 Drill out/cutout holes for pipe connection.

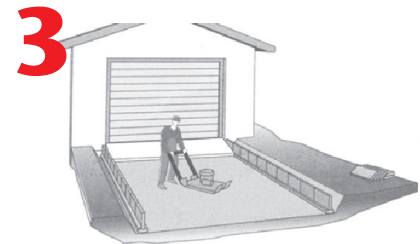

3 Position PointDrain on a 4" thick concrete slurry bed and ensure it is level.



4 Connect drainage pipe, check for leaks before backfilling.



5 Add riser (if required) and connect inlet pipe (if required). Surround PointDrain with good quality concrete. Finish with surfacing material.



6 Ensure finished surface is 1/8" higher than the grate to assist water drainage.

ACO Polymer Products, Inc.

Northeast Sales Office
9470 Pinecone Drive
Mentor, OH 44060
Tel: (440) 639-7230
Toll free: (800) 543-4764
Fax: (440) 639-7235

Southeast Sales Office
4211 Pleasant Road
Ft. Mill, SC 29708
Toll free: (800) 543-4764
Fax: (803) 802-1063

West Sales Office
825 W. Beechcraft St.
Casa Grande, AZ 85122
Tel: (520) 421-9988
Toll Free: (888) 490-9552
Fax: (520) 421-9899

Electronic Contact
info@acoself.com
www.acoself.com

Follow us on

