

ShowerDrain Premium ShowerChannel Plain Edge Channels

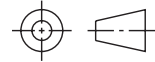

Plain Edge - Center Outlet

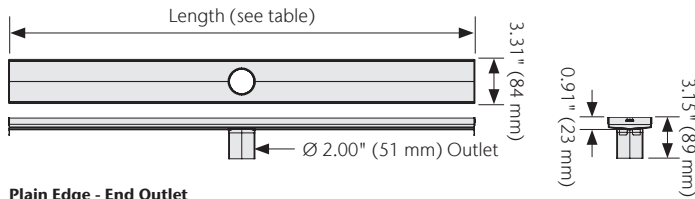

Plain Edge - End Outlet

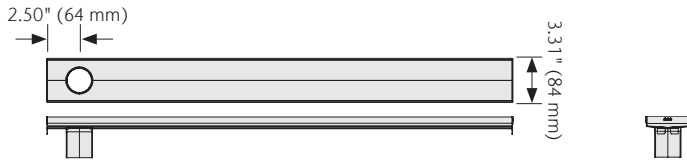

Plain Edge - Offset Outlet

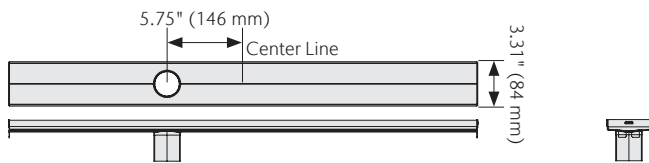

Parts	Classic Finish	Length in (mm)	Part No.	Weight lbs
Plain Edge - Center Outlet	Brushed Stainless	27.55 (700)	93861	2.5
		31.50 (800)	93864	2.6
		35.43 (900)	93865	3.0
		39.37 (1000)	93869	3.2
		47.24 (1200)	93872	3.7
		55.12 (1400)	93816	4.2
	Matte Black	27.55 (700)	37604	2.5
		31.50 (800)	37605	2.6
		35.43 (900)	37606	3.0
		39.37 (1000)	37607	3.2
		47.24 (1200)	37608	3.7
		59.05 (1500)	37609	4.2

Parts	Luxury Finish	Length in (mm)	Part No.	Weight lbs
Plain Edge - Center Outlet	Oil-Rubbed Bronze	27.55 (700)	93180	2.5
		31.50 (800)	37665	2.6
		35.43 (900)	93184	3.0
		39.37 (1000)	37666	3.2
		47.24 (1200)	93182	3.7
		55.12 (1400)	37667	4.2
	Satin Brass	27.55 (700)	37732	2.5
		31.50 (800)	37733	2.6
		35.43 (900)	37734	3.0
		39.37 (1000)	37735	3.2
		47.24 (1200)	37736	3.7
		55.12 (1400)	37737	4.2
Plain Edge - End Outlet	Rose Gold	27.55 (700)	37738	4.6
		27.55 (700)	37804	2.5
		31.50 (800)	37805	2.6
		35.43 (900)	37806	3.0
		39.37 (1000)	37807	3.2
		47.24 (1200)	37808	3.7
	Black Nickel	55.12 (1400)	37809	4.2
		59.05 (1500)	37810	4.6
		27.55 (700)	37874	2.5
		31.50 (800)	37875	2.6
		35.43 (900)	37876	3.0
		39.37 (1000)	37877	3.2
47.24 (1200)	37878	3.7		
55.12 (1400)	37879	4.2		
59.05 (1500)	37880	4.6		

Specification Clause

The ACO ShowerDrain channel and grate system shall be stainless steel grade 304 manufactured by ACO, Inc. USA.

Grate shall be Flag/Hawaii/Mix/Piano/Quadrato/Wave/Linear/Glass/Solid/Tile-In.

Shower channels shall be 3.31" (84 mm) wide with length as specified on Architects plans/specification.

Outlet Spigot diameter (Ø) shall be 2.0" (51 mm).

The PVC or Cast Iron Drain Flange—to provide connection to stainless steel spigot of shower channel and plumbing pipe system—shall be supplied by ACO, Inc. This drain flange will provide clamping ability for the waterproof membrane (supplied by others).

ACO recommends checking local plumbing codes prior to installation.

The system shall be installed in accordance with the manufacturer's instructions and recommendations.

Parts	Classic/Luxury Finish	Length in (mm)	Part No.	Weight lbs	
Plain Edge - End Outlet	Brushed Stainless	27.55 (700)	91877	2.5	
		31.50 (800)	91878	2.6	
		35.43 (900)	91879	3.0	
		39.37 (1000)	91880	3.2	
		47.24 (1200)	91881	3.7	
		55.12 (1400)	91882	4.2	
Plain Edge - Offset Outlet	Brushed Stainless	27.55 (700)	92226	2.5	
		31.50 (800)	92225	2.6	
		35.43 (900)	92224	3.0	
		39.37 (1000)	92223	3.2	
		PVC Drain Flange	-	93871	1.1
		Cast Iron Drain Flange	-	93808	4.7
Debris Strainer	Polished Steel	-	37381	0.9	
	Oil-Rubbed Bronze	-	37382	0.5	

ACO, Inc.

West Sales Office
825 W. Beechcraft Street
Casa Grande, AZ 85122
Tel: (520) 421-9988
Toll-Free: (888) 490-9552
Fax: (520) 421-9899

Northeast Sales Office
9470 Pinecone Drive
Mentor, OH 44060
Tel: (440) 639-7230
Toll-Free: (800) 543-4764
Fax: (440) 639-7235

Southeast Sales Office
4211 Pleasant Road
Fort Mill, SC 29708
Toll-Free: (800) 543-4764
Fax: (803) 802-1063

info@acousa.com
www.acousa.com

© December 2021 ACO, Inc.

All reasonable care has been taken in compiling the information in this document. All recommendations and suggestions on the use of ACO products are made without guarantee since the conditions of use are beyond the control of the company. It is the customer's responsibility to ensure that each product is fit for its intended purpose and that the actual conditions of use are suitable. ACO, Inc. reserves the right to change products and specifications without notice.

ACO. creating
the future of drainage



ACO Specification Information