

ShowerDrain Premium ShowerChannel Grate - Wave

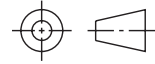

Wave

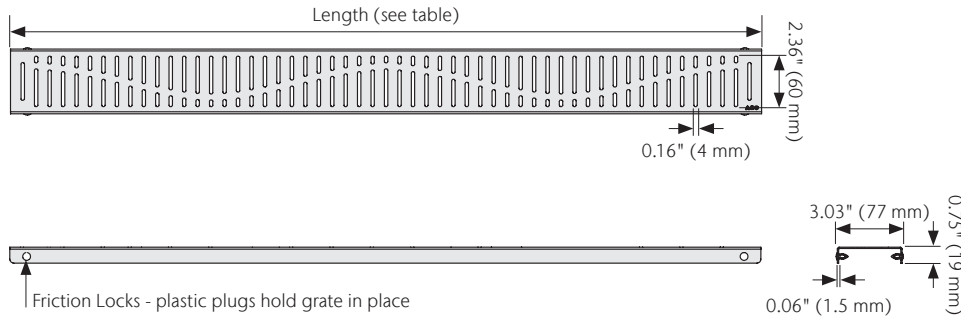

Specification Clause

The ACO ShowerDrain Wave grate shall be 1.5 mm (16 gauge) stainless steel grade 304 manufactured by ACO, Inc. USA.

Grates shall be 3.03" (77 mm) wide with length as specified on Architects plans/specification.

Shower channel shall be Plain Edge OR Flange Edge. See separate Spec Info Sheet for details.

ACO recommends checking local plumbing codes prior to installation.

The system shall be installed in accordance with the manufacturer's instructions and recommendations.

Classic Finish	Length in (mm)	Part No.	Intake in ² (cm ²)	Weight lbs
Brushed Stainless	27.55 (700)	37342	13.66 (88.2)	1.7
	31.50 (800)	37343	15.57 (100.5)	1.9
	35.43 (900)	37344	17.48 (112.8)	2.2
	39.37 (1000)	37345	19.39 (125.1)	2.5
	47.25 (1200)	37346	23.20 (149.7)	2.9
	55.12 (1400)	37413	27.01 (174.3)	3.4
59.05 (1500)	37391	31.33 (202.2)	3.9	
Polished Chrome	27.55 (700)	37527	13.66 (88.2)	1.7
	31.50 (800)	37528	15.57 (100.5)	1.9
	35.43 (900)	37529	17.48 (112.8)	2.2
	39.37 (1000)	37530	19.39 (125.1)	2.5
	47.25 (1200)	37531	23.20 (149.7)	2.9
	55.12 (1400)	37532	27.01 (174.3)	3.4
59.05 (1500)	37533	31.33 (202.2)	3.9	
Matte Black	27.55 (700)	37576	13.66 (88.2)	1.7
	31.50 (800)	37577	15.57 (100.5)	1.9
	35.43 (900)	37578	17.48 (112.8)	2.2
	39.37 (1000)	37579	19.39 (125.1)	2.5
	47.25 (1200)	37580	23.20 (149.7)	2.9
	55.12 (1400)	37581	27.01 (174.3)	3.4
59.05 (1500)	37582	31.33 (202.2)	3.9	

Luxury Finish	Length in (mm)	Part No.	Intake in ² (cm ²)	Weight lbs
Oil-Rubbed Bronze	27.55 (700)	37312	13.66 (88.2)	1.7
	31.50 (800)	37643	15.57 (100.5)	1.9
	35.43 (900)	37308	17.48 (112.8)	2.2
	39.37 (1000)	37644	19.39 (125.1)	2.5
	47.25 (1200)	37302	23.20 (149.7)	2.9
	55.12 (1400)	37645	27.01 (174.3)	3.4
59.05 (1500)	37646	31.33 (202.2)	3.9	
Satin Brass	27.55 (700)	37704	13.66 (88.2)	1.7
	31.50 (800)	37705	15.57 (100.5)	1.9
	35.43 (900)	37706	17.48 (112.8)	2.2
	39.37 (1000)	37707	19.39 (125.1)	2.5
	47.25 (1200)	37708	23.20 (149.7)	2.9
	55.12 (1400)	37709	27.01 (174.3)	3.4
59.05 (1500)	37710	31.33 (202.2)	3.9	
Rose Gold	27.55 (700)	37776	13.66 (88.2)	1.7
	31.50 (800)	37777	15.57 (100.5)	1.9
	35.43 (900)	37778	17.48 (112.8)	2.2
	39.37 (1000)	37779	19.39 (125.1)	2.5
	47.25 (1200)	37780	23.20 (149.7)	2.9
	55.12 (1400)	37781	27.01 (174.3)	3.4
59.05 (1500)	37782	31.33 (202.2)	3.9	
Black Nickel	27.55 (700)	37846	13.66 (88.2)	1.7
	31.50 (800)	37847	15.57 (100.5)	1.9
	35.43 (900)	37848	17.48 (112.8)	2.2
	39.37 (1000)	37849	19.39 (125.1)	2.5
	47.25 (1200)	37850	23.20 (149.7)	2.9
	55.12 (1400)	37851	27.01 (174.3)	3.4
59.05 (1500)	37852	31.33 (202.2)	3.9	

Grate Lifting Key (part no. 37339) included.

ACO, Inc.

West Sales Office
825 W. Beechcraft Street
Casa Grande, AZ 85122
Tel: (520) 421-9988
Toll-Free: (888) 490-9552
Fax: (520) 421-9899

Northeast Sales Office
9470 Pinecone Drive
Mentor, OH 44060
Tel: (440) 639-7230
Toll-Free: (800) 543-4764
Fax: (440) 639-7235

Southeast Sales Office
4211 Pleasant Road
Fort Mill, SC 29708
Toll-Free: (800) 543-4764
Fax: (803) 802-1063

info@acousa.com
www.acousa.com

© December 2021 ACO, Inc.

All reasonable care has been taken in compiling the information in this document. All recommendations and suggestions on the use of ACO products are made without guarantee since the conditions of use are beyond the control of the company. It is the customer's responsibility to ensure that each product is fit for its intended purpose and that the actual conditions of use are suitable. ACO, Inc. reserves the right to change products and specifications without notice.

ACO. creating the future of drainage



ACO Specification Information