

Mesh Grate - MOD200

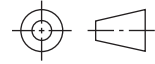

300mm

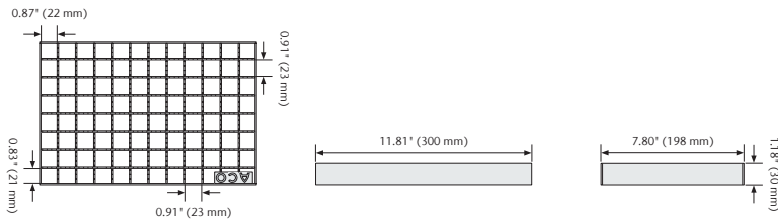

Specification Clause

Used with ACO Modular 200 channels. Made from AISI 304 or AISI 316L. Load class per EN 1433.

ACO recommends checking local plumbing codes prior to installation.

500mm

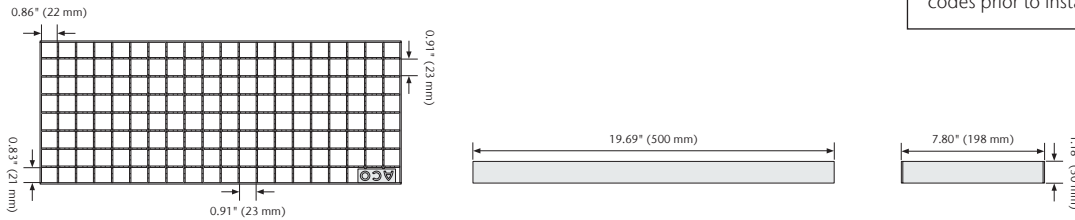

1000mm

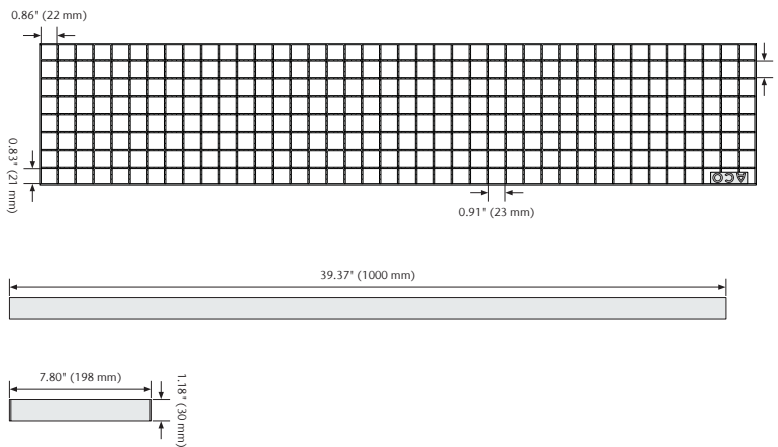

Parts

	Part No.	Grate Material	Weight lbs.	Intake sq. in.	EN1433 Load Class
Mesh Grate 300mm	<b>414140</b>	AISI 304	3.5	67.0	A15
	<b>414190</b>	AISI 316L	3.5	67.0	A15
Mesh Grate 500mm	<b>92200</b>	AISI 304	6.6	127.6	A15
	<b>92250</b>	AISI 316L	6.6	127.6	A15
Mesh Grate 1000mm	<b>92201</b>	AISI 304	12.8	256.0	A15
	<b>92251</b>	AISI 316L	12.8	256.0	A15

ACO, Inc.

West Sales Office  
825 W. Beechcraft Street  
Casa Grande, AZ 85122  
Tel: (520) 421-9988  
Toll-Free: (888) 490-9552  
Fax: (520) 421-9899

Northeast Sales Office  
9470 Pinecone Drive  
Mentor, OH 44060  
Tel: (440) 639-7230  
Toll-Free: (800) 543-4764  
Fax: (440) 639-7235

Southeast Sales Office  
4211 Pleasant Road  
Fort Mill, SC 29708  
Toll-Free: (800) 543-4764  
Fax: (803) 802-1063

info@acousa.com  
www.acousa.com

© June 2021 ACO, Inc.  
All reasonable care has been taken in compiling the information in this document. All recommendations and suggestions on the use of ACO products are made without guarantee since the conditions of use are beyond the control of the company. It is the customer's responsibility to ensure that each product is fit for its intended purpose and that the actual conditions of use are suitable. ACO, Inc. reserves the right to change products and specifications without notice.

ACO. creating the future of drainage

