

Heelsafe Grate - MOD125

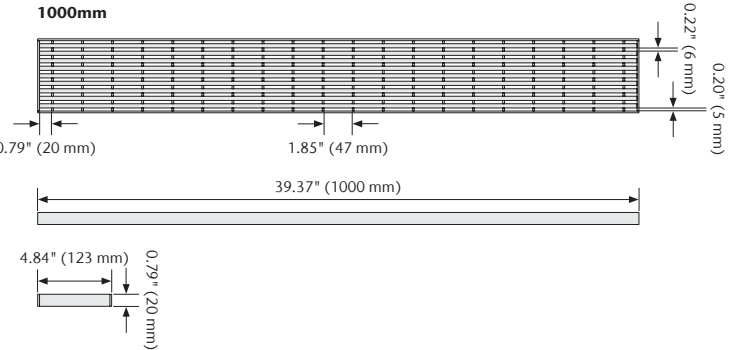
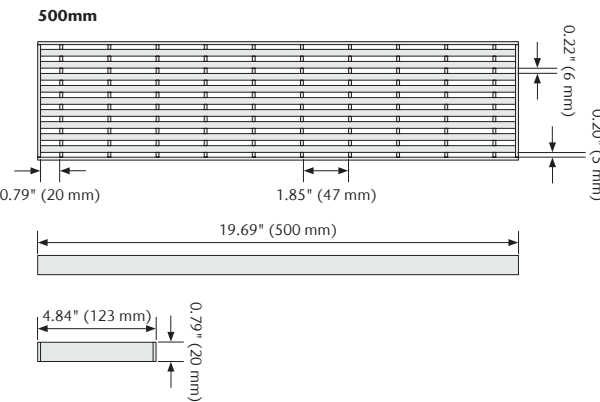
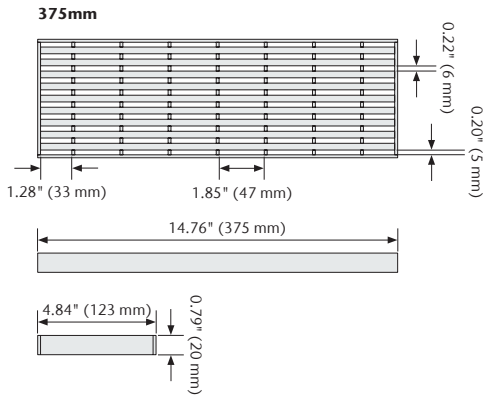
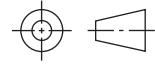

Specification Clause

Used with ACO Modular 125 channels. Made from AISI 304 or AISI 316L. Load class per EN 1433.

ACO recommends checking local plumbing codes prior to installation.

Parts	Part No.	Grate Material	Weight lbs.	Intake sq. in.	EN1433 Load Class
Heelsafe Grate 375mm	414135	AISI 304	3.4	29.0	B125
	414185	AISI 316L	3.4	29.0	B125
Heelsafe Grate 500mm	96819	AISI 304	4.6	38.8	B125
	401238	AISI 316L	4.6	38.8	B125
Heelsafe Grate 1000mm	96818	AISI 304	9.0	78.1	B125
	401237	AISI 316L	9.0	78.1	B125

ACO, Inc.

West Sales Office
825 W. Beechcraft Street
Casa Grande, AZ 85122
Tel: (520) 421-9988
Toll-Free: (888) 490-9552
Fax: (520) 421-9899

Northeast Sales Office
9470 Pinecone Drive
Mentor, OH 44060
Tel: (440) 639-7230
Toll-Free: (800) 543-4764
Fax: (440) 639-7235

Southeast Sales Office
4211 Pleasant Road
Fort Mill, SC 29708
Toll-Free: (800) 543-4764
Fax: (803) 802-1063

info@acousa.com
www.acousa.com

© June 2021 ACO, Inc.
All reasonable care has been taken in compiling the information in this document. All recommendations and suggestions on the use of ACO products are made without guarantee since the conditions of use are beyond the control of the company. It is the customer's responsibility to ensure that each product is fit for its intended purpose and that the actual conditions of use are suitable. ACO, Inc. reserves the right to change products and specifications without notice.

ACO. creating the future of drainage



ACO Specification Information