

Closing End Cap - SlotDrain 20

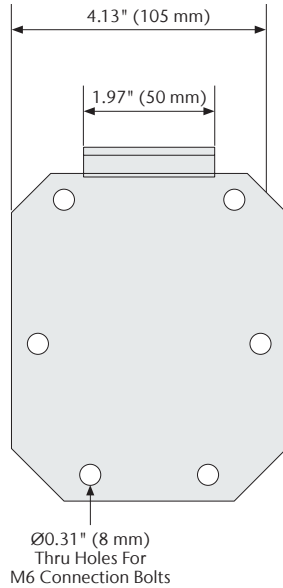
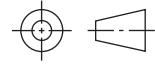

Specification Clause

ACO SlotDrain 20 closing end caps. Overall width 4.13", total height varies. Made from 16ga (1.5 mm) AISI 304 or AISI 316L, pickle passivated finish. All caps provided with NBR seal and connection bolts. Used on ACO Slot 20 channels.

ACO recommends checking local plumbing codes prior to installation.

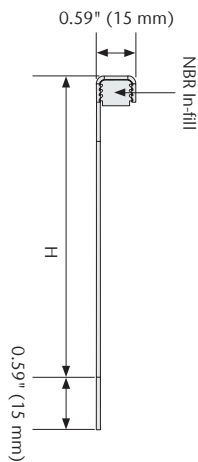

Part No.	Material	Height (H) in (mm)	Weight lbs.	Part No.	Material	Height (H) in (mm)	Weight lbs.
92324	AISI 304	2.76 (70)	0.4	92374	AISI 316L	2.76 (70)	0.4
92325	AISI 304	2.95 (75)	0.4	92375	AISI 316L	2.95 (75)	0.4
92326	AISI 304	3.15 (80)	0.5	92376	AISI 316L	3.15 (80)	0.5
92327	AISI 304	3.54 (90)	0.5	92377	AISI 316L	3.54 (90)	0.5
92328	AISI 304	3.94 (100)	0.5	92378	AISI 316L	3.94 (100)	0.5
92329	AISI 304	4.33 (110)	0.5	92379	AISI 316L	4.33 (110)	0.5
92330	AISI 304	4.72 (120)	0.5	92380	AISI 316L	4.72 (120)	0.5

ACO, Inc.

West Sales Office
825 W. Beechcraft Street
Casa Grande, AZ 85122
Tel: (520) 421-9988
Toll-Free: (888) 490-9552
Fax: (520) 421-9899

Northeast Sales Office
9470 Pinecone Drive
Mentor, OH 44060
Tel: (440) 639-7230
Toll-Free: (800) 543-4764
Fax: (440) 639-7235

Southeast Sales Office
4211 Pleasant Road
Fort Mill, SC 29708
Tel: (440) 639-7230
Toll-Free: (800) 543-4764
Fax: (803) 802-1063

info@acousa.com
www.acousa.com

© December 2021 ACO, Inc.
All reasonable care has been taken in compiling the information in this document. All recommendations and suggestions on the use of ACO products are made without guarantee since the conditions of use are beyond the control of the company. It is the customer's responsibility to ensure that each product is fit for its intended purpose and that the actual conditions of use are suitable. ACO, Inc. reserves the right to change products and specifications without notice.

ACO. creating
the future of drainage



ACO Specification Information