

BoxDrain Grates - Frameless Ladder

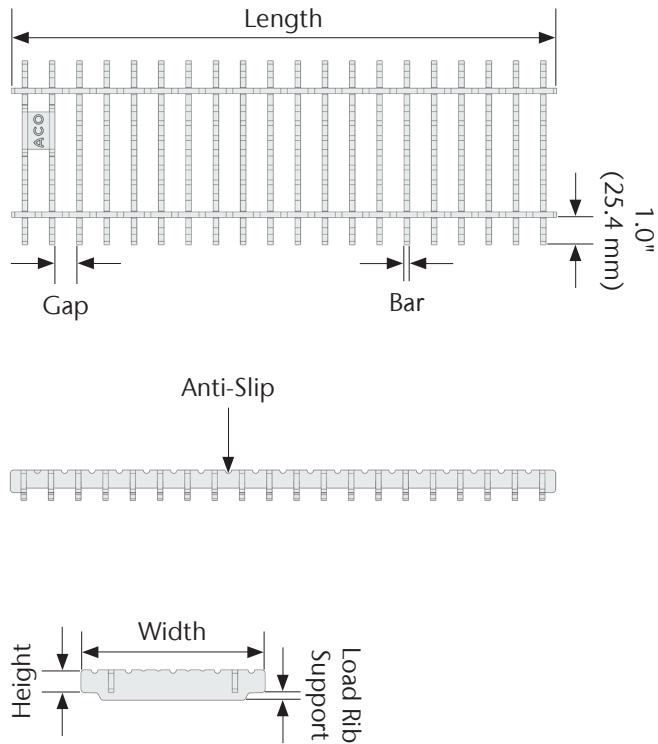
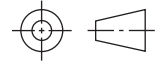

**Specification Clause**

ACO BoxDrain Frameless Ladder Grates. Used with ACO BoxDrain Channels. Made from AISI 304 or 316L grade stainless steel with electropolish finish. Fully welded hygienic joints. Fully drainable, inspectable and cleanable. Frameless Ladder Grate is designed for superior hygienic performance. Slip-resistant. Load Class Per ASME A112.6.3. Certified to NSF/ANSI/3-a Standard 14159-1.

ACO recommends checking local plumbing codes prior to installation.

ACO Specification Information

Parts	Part No.	Width in (mm)	Length in (mm)	Height in (mm)	Gap in (mm)	Bar in (mm)	Grate Material	Weight lbs.	EN1253 Load Class	ASME Load Class	Load Rib Support
Frameless Grate - BoxDrain 150	446290	4.65 (118)	19.69 (500)	0.79 (20)	0.79 (20)	0.16 (4)	AISI 304	4.8	R50	Light Duty	Y
	446292	4.65 (118)	19.69 (500)	0.79 (20)	0.79 (20)	0.20 (5)	AISI 304	6.2	M125	Medium Duty	Y
	446291	4.65 (118)	19.69 (500)	0.79 (20)	0.79 (20)	0.16 (4)	AISI 316L	4.8	R50	Light Duty	Y
	446293	4.65 (118)	19.69 (500)	0.79 (20)	0.79 (20)	0.20 (5)	AISI 316L	6.2	M125	Medium Duty	Y
Frameless Grate - BoxDrain 200	446246	6.61 (168)	19.69 (500)	0.79 (20)	0.79 (20)	0.16 (4)	AISI 304	6.5	R50	Light Duty	Y
	446250	6.61 (168)	15.75 (400)	0.79 (20)	0.79 (20)	0.16 (4)	AISI 304	5.2	R50	Light Duty	Y
	446248	6.61 (168)	19.69 (500)	0.79 (20)	0.79 (20)	0.20 (5)	AISI 304	8.5	M125	Medium Duty	Y
	446252	6.61 (168)	15.75 (400)	0.79 (20)	0.79 (20)	0.20 (5)	AISI 304	6.8	M125	Medium Duty	Y
	446247	6.61 (168)	19.69 (500)	0.79 (20)	0.79 (20)	0.16 (4)	AISI 316L	6.5	R50	Light Duty	Y
	446251	6.61 (168)	15.75 (400)	0.79 (20)	0.79 (20)	0.16 (4)	AISI 316L	5.2	R50	Light Duty	Y
	446249	6.61 (168)	19.69 (500)	0.79 (20)	0.79 (20)	0.20 (5)	AISI 316L	8.5	M125	Medium Duty	Y
Frameless Grate - BoxDrain 300	446253	6.61 (168)	15.75 (400)	0.79 (20)	0.79 (20)	0.20 (5)	AISI 316L	6.8	M125	Medium Duty	Y
	446254	10.55 (268)	19.69 (500)	0.79 (20)	0.79 (20)	0.16 (4)	AISI 304	9.6	R50	Light Duty	Y
	446258	10.55 (268)	11.81 (300)	0.79 (20)	0.79 (20)	0.16 (4)	AISI 304	5.9	R50	Light Duty	Y
	446256	10.55 (268)	19.69 (500)	0.79 (20)	0.79 (20)	0.20 (5)	AISI 304	14.3	M125	Medium Duty	Y
	446260	10.55 (268)	11.81 (300)	0.79 (20)	0.79 (20)	0.20 (5)	AISI 304	8.7	M125	Medium Duty	Y
	446255	10.55 (268)	19.69 (500)	0.79 (20)	0.79 (20)	0.16 (4)	AISI 316L	9.6	R50	Light Duty	Y
	446259	10.55 (268)	11.81 (300)	0.79 (20)	0.79 (20)	0.16 (4)	AISI 316L	5.9	R50	Light Duty	Y
	446257	10.55 (268)	19.69 (500)	0.79 (20)	0.79 (20)	0.20 (5)	AISI 316L	14.3	M125	Medium Duty	Y
	446261	10.55 (268)	11.81 (300)	0.79 (20)	0.79 (20)	0.20 (5)	AISI 316L	8.7	M125	Medium Duty	Y

**ACO, Inc.**

West Sales Office  
825 W. Beechcraft Street  
Casa Grande, AZ 85122  
Tel: (520) 421-9988  
Toll-Free: (888) 490-9552  
Fax: (520) 421-9899

Northeast Sales Office  
9470 Pinecone Drive  
Mentor, OH 44060  
Tel: (440) 639-7230  
Toll-Free: (800) 543-4764  
Fax: (440) 639-7235

Southeast Sales Office  
4211 Pleasant Road  
Fort Mill, SC 29708  
Toll-Free: (800) 543-4764  
Fax: (803) 802-1063

info@acousa.com  
www.acousa.com

© December 2021 ACO, Inc.

All reasonable care has been taken in compiling the information in this document. All recommendations and suggestions on the use of ACO products are made without guarantee since the conditions of use are beyond the control of the company. It is the customer's responsibility to ensure that each product is fit for its intended purpose and that the actual conditions of use are suitable. ACO, Inc. reserves the right to change products and specifications without notice.

ACO. creating the future of drainage

