

Long Sweep P-Trap

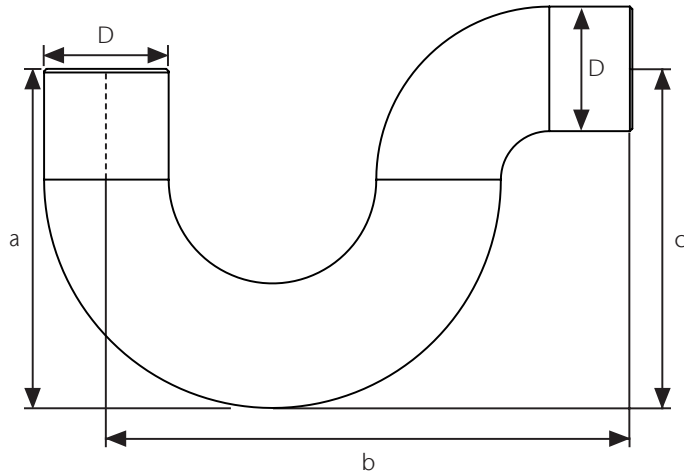
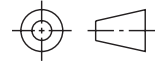

Specifications

General

ACO Long Sweep P-Trap. Deep Seal Water Trap to be over 4". Long Sweep Elbows allow smooth entry of cleaning tools in case of blockage. Designed for no-hub or welded connection.

ACO recommends checking local plumbing codes prior to installation.

| | Part No. | Diameter (D) in (mm) | Length (a) in (mm) | Length (b) in (mm) | Length (c) in (mm) | Thickness in (mm) | Material | Weight lbs |
|----|----------|-------------------------|-----------------------|-----------------------|-----------------------|----------------------|----------|---------------|
| 3" | 448850 | 3.5 (88.9) | 11.25 (286) | 15 (381) | 9.25 (235) | SCH10 (3.1) | 316L | 9.6 |
| | 448856 | 3.5 (88.9) | 11.25 (286) | 15 (381) | 9.25 (235) | SCH40 (5.5) | 316L | 15.6 |

| | Part No. | Diameter (D) in (mm) | Length (a) in (mm) | Length (b) in (mm) | Length (c) in (mm) | Thickness in (mm) | Material | Weight lbs |
|----|----------|-------------------------|-----------------------|-----------------------|-----------------------|----------------------|----------|---------------|
| 4" | 448851 | 4.50 (114.3) | 17.75 (451) | 19 (483) | 12.25 (311) | SCH10 (3.1) | 316L | 17.6 |
| | 448857 | 4.50 (114.3) | 17.75 (451) | 19 (483) | 12.25 (311) | SCH40 (6) | 316L | 28.9 |

| | Part No. | Diameter (D) in (mm) | Length (a) in (mm) | Length (b) in (mm) | Length (c) in (mm) | Thickness in (mm) | Material | Weight lbs |
|----|----------|-------------------------|-----------------------|-----------------------|-----------------------|----------------------|----------|---------------|
| 6" | 448852 | 6.625 (168.3) | 21.8 (554) | 27 (686) | 18.31 (465) | SCH10 (3.4) | 316L | 38.8 |
| | 448858 | 6.625 (168.3) | 21.8 (554) | 27 (686) | 18.31 (465) | SCH40 (7.1) | 316L | 74.1 |

| | Part No. | Diameter (D) in (mm) | Length (a) in (mm) | Length (b) in (mm) | Length (c) in (mm) | Thickness in (mm) | Material | Weight lbs |
|----|----------|-------------------------|-----------------------|-----------------------|-----------------------|----------------------|----------|---------------|
| 8" | 448853 | 8.625 (219) | 28.8 (732) | 35 (889) | 24.31 (617) | SCH10 (3.8) | 316L | 73.5 |
| | 448859 | 8.625 (219) | 28.8 (732) | 35 (889) | 24.31 (617) | SCH40 (7.2) | 316L | 146.5 |

| | Part No. | Diameter (D) in (mm) | Length (a) in (mm) | Length (b) in (mm) | Length (c) in (mm) | Thickness in (mm) | Material | Weight lbs |
|-----|----------|-------------------------|-----------------------|-----------------------|-----------------------|----------------------|----------|---------------|
| 10" | 448854 | 10.75 (273) | 35.87 (911) | 43 (1092) | 30.38 (772) | SCH10 (4.2) | 316L | 126.6 |
| | 448860 | 10.75 (273) | 35.87 (911) | 43 (1092) | 30.38 (772) | SCH40 (9.3) | 316L | 257.4 |

| | Part No. | Diameter (D) in (mm) | Length (a) in (mm) | Length (b) in (mm) | Length (c) in (mm) | Thickness in (mm) | Material | Weight lbs |
|-----|----------|-------------------------|-----------------------|-----------------------|-----------------------|----------------------|----------|---------------|
| 12" | 448855 | 12.75 (324) | 42.87 (1089) | 51 (1295) | 36.38 (924) | SCH10 (4.6) | 316L | 195.5 |
| | 448861 | 12.75 (324) | 42.87 (1089) | 51 (1295) | 36.38 (924) | SCH40 (10.3) | 316L | 376.5 |

ACO, Inc.

West Sales Office info@acousa.com
 825 W. Beechcraft Street www.acousa.com
 Casa Grande, AZ 85122 www.acobuildingdrainage.us
 Tel: (520) 421-9988
 Toll-Free: (888) 490-9552
 Fax: (520) 421-9899

© February 2022 ACO, Inc.
 All reasonable care has been taken in compiling the information in this document. All recommendations and suggestions on the use of ACO products are made without guarantee since the conditions of use are beyond the control of the company. It is the customer's responsibility to ensure that each product is fit for its intended purpose and that the actual conditions of use are suitable. ACO, Inc. reserves the right to change products and specifications without notice.

ACO. creating the future of drainage



ACO Specification Information